

Dismantling Joints Fabricated DN40 to DN300 (PN10,16,25,40)

Dismantling Joint (Fabricated)

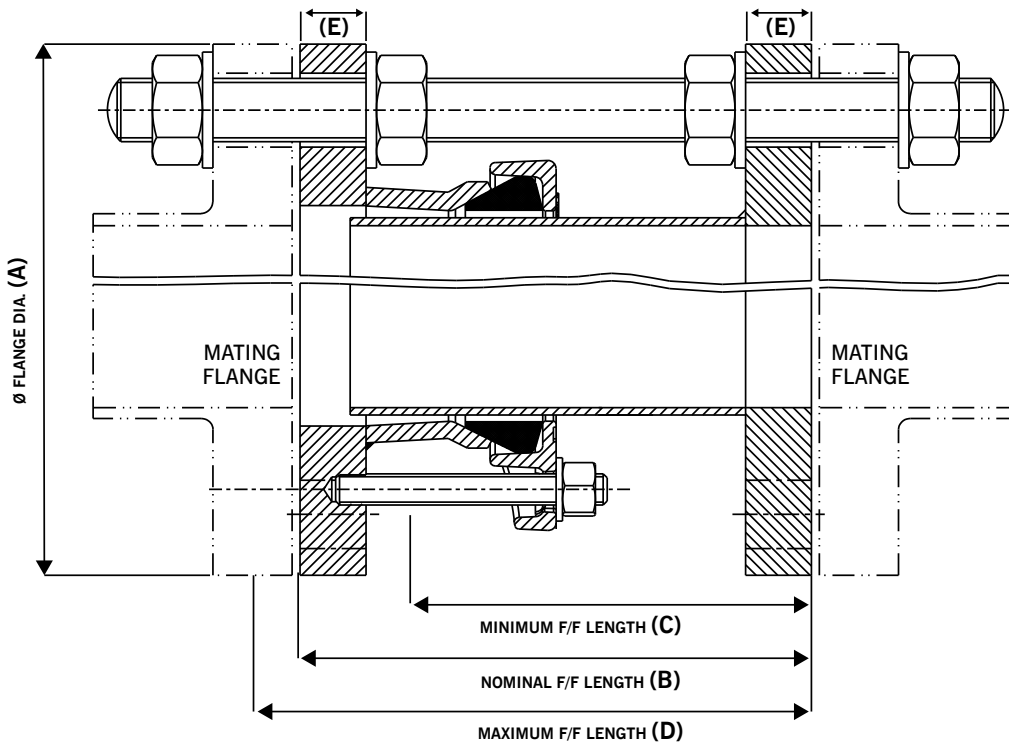

Note: Maximum Longitudinal F/F Adjustment = Maximum F/F Length – Minimum F/F Length

Dismantling Joints (Standard Product)

Table provides details of standard product – for products offering longer flange dimensions and / or increased longitudinal adjustment contact Viking Johnson.

Nom	Drilling	Flange Details			Flange to Flange Details				Tie Rod Details				
		Flange Thickness		Flange OD	Nominal Length	Minimum Length	Maximum Length	Steel Tie Rod			Stainless Steel Tie Rod		
		Flange Adaptor E (mm)	Spigot E (mm)	A (mm)	B (mm)	C (mm)	D (mm)	Dia x Length (mm)	No.	Total Weight of DJ (kg)	Dia x Length (mm)	No.	Total Weight of DJ (kg)
40	PN10,16,25,40	18	18	150	187	167	207	M16 x 300	4	7.8	M16 x 300	4	7.8
100	PN25,40	25	25	235	194	174	214	M20 x 320	4	19.2	M20 x 320	4	19.2
125	PN25,40	25	25	270	194	174	214	M24 x 330	4	26.2	M24 x 330	4	26.2
150	PN25	25	25	300	194	174	214	M24 x 330	4	28.9	M24 x 330	4	28.9
150	PN40	25	25	300	194	174	214	M24 x 330	4	28.8	M24 x 330	4	28.8
200	PN25	25	25	360	194	174	214	M24 x 340	4	37.5	M24 x 340	4	37.5
200	PN40	25	25	375	194	174	214	M27 x 350	4	42.6	M27 x 350	4	42.6
250	PN25	25	25	425	194	174	214	M27 x 350	4	49.1	M27 x 350	4	49.1
250	PN40	25	25	450	194	174	214	M30 x 370	4	57.9	M30 x 370	4	57.9
300	PN25	25	25	485	194	174	214	M27 x 350	4	57.1	M27 x 350	4	57.1
300	PN40	25	25	515	194	174	214	M30 x 380	4	69.8	M30 x 380	4	69.8

Every effort has been made to ensure that the information contained in this publication is accurate at the time of publishing. Crane Ltd assumes no responsibility or liability for typographical errors or omissions or for any misinterpretation of the information within the publication and reserves the right to change without notice.

Dismantling Joints Fabricated DN40 to DN300 (PN10,16,25,40)

Datasheet

4/4

Technical Information

Working Pressure Rating

Water - In accordance with the flange rating
Gas 6 bar

Vacuum Pressure

Capable of accommodating a vacuum pressure of -0.7 bar

Site Test Pressure

1.5 times working pressure for short duration (2 hours)

Angularity

Dismantling joints are in essence double flanged pipe where the flange to flange dimension can be adjusted, and therefore are not able to accommodate any angularity.

Bolt Torque/Spanner

M12; Torque 55-65Nm on every bolt
M16; Torque 95-110Nm on every bolt

Tie rods

Torque is a function of the flange connecting gasket, not supplied by Viking Johnson; consult flange gasket supplier.

Temperature Rating of Product

EPDM -20°C to +90°C

Nitrile -20°C to +90°C

For use on applications with fluctuating and / or elevated temperatures (> 60°C) may require regular maintenance to re-tighten the bolts and must be included in any maintenance schedule.

Approvals

The following water contact materials used in Dismantling Joints are approved for use with potable water:-

Rilsan Nylon 11:

- WRAS, DVGW, W270, ACS & KIWA

EPDM Gaskets:

- WRAS

Materials & Relevant Standards

Flange Drilling

BS EN1092-1
(formerly BS4504), ISO7005

Fabricated Flange Adaptor Body

Rolled Steel to BS EN 10025-2:
Grade S275

End Rings

Rolled Steel to BS EN 10025-2:
Grade S275

Ductile Iron to BS EN1563:
Symbol EN-GJS-450-10

Sleeve Options

- Steel Tube to BS EN10255
- Steel Tube to BS EN10216-1:
Grade P265TR1
- Rolled Steel to BS EN 10025-2:
Grade S275

Fabricated Flange Spigot:

Rolled steel to BS EN10025-2:
Grade S275

Steel Spigot Options:

- Steel tube to BS EN10255
- Steel tube to BS EN10216-1:
Grade P265TR1
- Rolled steel to BS EN10025-2:
Grade S275

Gaskets

Standard:

- EPDM to BS EN681-1: Type WA
- Other gasket grades are available contact Viking Johnson.

Coatings

Flange Adaptor, Spigot
& End Ring:

- Rilsan Nylon 11 to
WIS 4-52-01 Part 1

Option 1 Flange Adaptor
bolts & Nuts:

- Sheraplex to WIS 4-52-03

Steel Tie Rods/Nuts:

- Zn³ Zinc coated

Tie Rods, Studs, Nuts and Washers

The following two options are as standard variants:-

Option 1: Zinc Plated Steel

Tie Rods

ASTM A193 (Grade B7/MB7)
equivalent to BS EN10269:+A1:
Name 42CrMo4 (Yield 725N/mm²)

Tie Rod Nuts

ASTM A194 Grade 2H/M2H
equivalent to BS EN20898-2:
Property Class 8.00

Flange Adaptor Studs

Steel to BS EN ISO898-1:
Property Class 4.8

Flange Adaptor Nuts

Steel to BS4190: Grade 4

Flange Adaptor Washers

Stainless Steel to BS1449:Part 2:
Grade 304S15

Option 2: Stainless Steel

Tie Rods

Stainless Steel to BS EN3506-1:
Grade A4 Property Class 70
(Yield 450N/mm²)

Tie Rod Nuts

Stainless Steel to BS EN3506-2:
Grade A4 Property Class 80

Flange Adaptor Studs

Stainless Steel to
BS EN ISO 3506-1: grade A4
property class 50

Flange Adaptor Nuts

Stainless Steel to
BS EN ISO 3506-2: grade A4
property class 80

Flange Adaptor Washers

Stainless Steel to BS1449:
Part 2: Grade 304S15